

By the State of New York

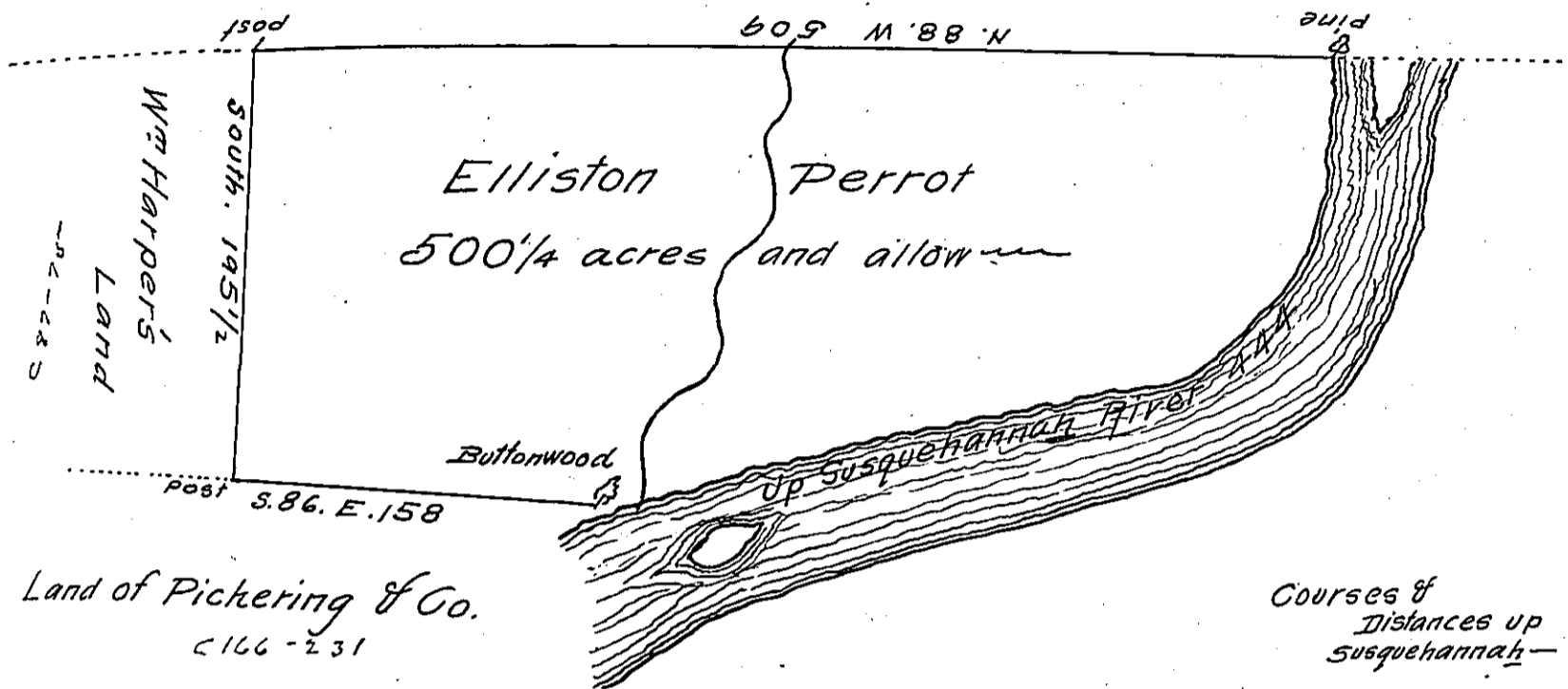

Courses & Distances up Susquehanna—

N 78	E	294
N 52	E	34
N 33	E	52
N 12	E	32
N 3	E	32
		444

The Draught of a Tract of land called — situate on Susquehanna River adjoining the State of New York in the County of Luzerne. Survey'd the 15th day of September Anno Domi. 1786 to Elliston Perrot. Containing five hundred acres and one quarter of an acre. in pursuance of his Warrant bearing date at Philad^a the seven-teenth day of May Anno Dom 1785. N^o 86

W^m Maclay D.S.

To John Lukens Esq^r S.G.
of Pennsylvania

IN TESTIMONY that the above is a copy of the original remaining on file in the Department of Internal Affairs of Pennsylvania, made conformably to an Act of Assembly approved the 16th day of February, 1833, I have hereunto set my Hand and caused the Seal of said Department to be affixed at Harrisburg, this fifteenth day of June 1906

Isaac B. Brown
Secretary of Internal Affairs.